

6.2. MECHANISM SECTION

6.2.1. Disassembly Method

This procedure starts with the condition that the cabinet parts and Main C.B.A. have been removed.
When reassembling, perform the step(s) in the reverse order.

Perform all disassembly and alignments procedures in STOP Position except disassembly and alignment procedures which have the special Notes.

STEP LOC. No.	Prior Step (s)	Part	Fig. No.	Remove
①	-	Cassette Up Unit	DM3-1,2	2(S-1), 2(L-1)
②	-	Cylinder Ass'y	DM4-1	3(S-1), Hooking Portion
③	2	Upper Cylinder Unit	DM4-2,3	(S-1)
④	2	Cylinder/Head Amp F.P.C.	DM4-2,3	FP3501
⑤	2	Bulge Chip	DM4-2,3	(S-2)
⑥	-	P.C.B. Angle	DM5	(S-1)
⑦	-	Mechanism F.P.C. Unit	DM6-1,2	4(S-1), Hooking Portion, double-sided adhesive tape, Unsolder Gear Alignment (x1)
⑧	1,9	Tension Unit	DM7-1,2	(C-1), Hooking Portion
⑨	1,8	Reel Table Unit	DM7-1,2	(C-2), (W-1)
⑩	1,8,9	Rev Clutch	DM8	(C-1)
⑪	1	Take Gear	DM9-1,2	(L-1)
⑫	1,11	Rev Brake Arm Unit	DM9-1,2	(C-1), Hooking Portion
⑬	-	A/C Head Unit	DM10	(S-1), Unsolder
⑭	-	Capstan Belt	DM11	-
⑮	6,13,14	Capstan Unit	DM12	2(S-1), (S-2)
⑯	1,6,7,11,12,14	Idler Arm Unit	DM13	(C-1)
⑰	2	Mechanism Support Angle	DM14	(S-1)
⑱	1	Reduction Gear B	DM15	(C-1)
⑲	-	Reduction Gear A	DM16	(C-1)
⑳	1,18	Reduction Gear Unit	DM16	2(S-1)
㉑	1	Pinch Arm Unit	DM17-1,2	(C-1)
㉒	1	Opener	DM17-1,2	(S-1)
㉓	1,11,21,22	P5 Arm Unit	DM17-1,2	Hooking Portion
㉔	1,17	Takeup Post Unit	DM18-1,2	(S-1)
㉕	1	Supply Post Unit	DM18-1,2	(S-2)
㉖	-	Impedance Roller Unit	DM19-1,2	(C-1)
㉗	1,2,13,24,25	Loading Base Unit	DM19-1,2	4(S-1)
㉘	1,2,8,9,13,24,25,27	Takeup Loading Arm Unit	DM20	- Gear Alignment (x1)
㉙	1,2,8,9,13,24,25,27	Supply Loading Arm Unit	DM21-1,2,3	- Gear Alignment (x2)
㉚	8,9,19	Loading Motor Unit	DM22	2(S-1)
㉛	1,2,8,9,10,18,19,20,24,25,27,29,30	Main Cam Unit	DM22	-
㉜	1,2,8,9,10,18,19,20,24,25,27,29,30,31	Pinch Toggle	DM22	-

↑
A↑
B↑
C↑
D↑
E

How to read chart shown above:

- A: Order of Procedure steps.
When reassembling, perform steps(s) in reverse order.
These numbers are also used as the identification (location) No. of parts in Figures.
- B: Steps to be completed prior to the current step.
- C: Part to be removed or installed.
- D: Fig. No. showing Procedure or Part Location.
- E: Identification of part to be removed, unhooked, unlocked, released, unplugged, unclamped, or unsoldered.
3(S-1)=3 Screws (S-1), 3(W-1)=3 Washers (W-1),
(C-1)=Cut Washer (C-1), 2(L-1)=2 Looking Tabs (L-1)

CAUTION:

- Use a wrist strap to provide ESD protection while disassembling or assembling.
- Removed Cut Washer is not reusable. If removed, install a new one.

Following Cut Washers are to be used:

Ref. No.	Part No.
409	VMXW0217
411	VMXW0213
419	VMX2026

6.2.2. Inner Parts Location

Note: BOX indicates alignment (Gear alignment or Tape Interchangeability adjustment) required when a part is replaced.

6.2.2.1. TOP VIEW

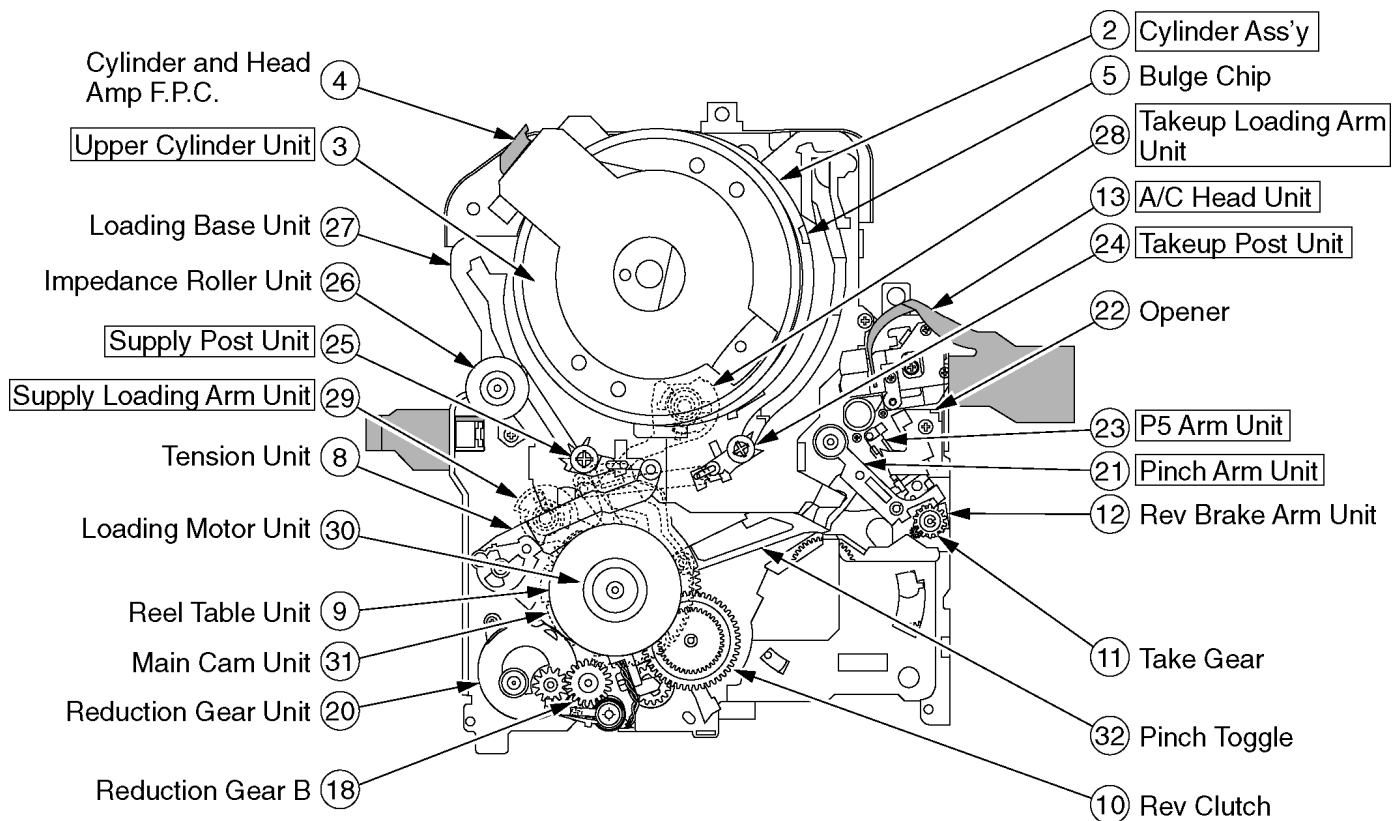

Fig. DM1-1

6.2.2.2. BOTTOM VIEW

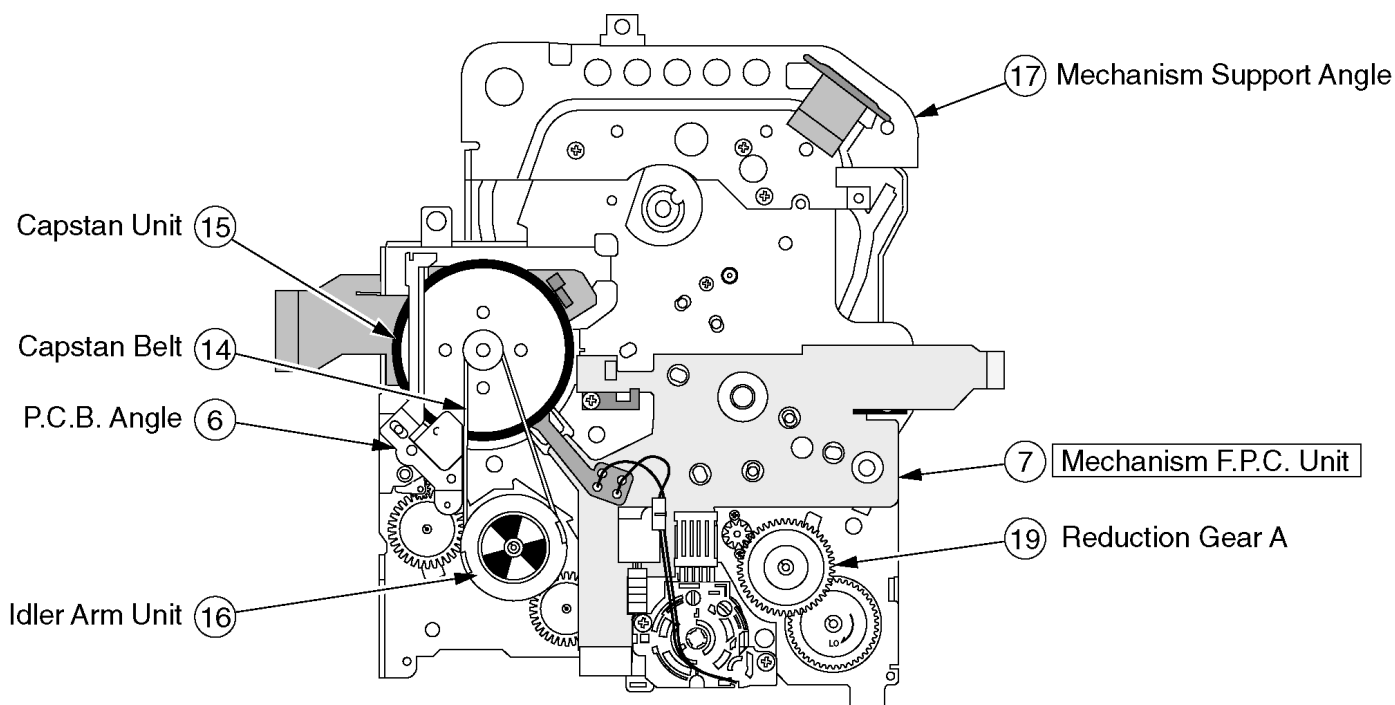
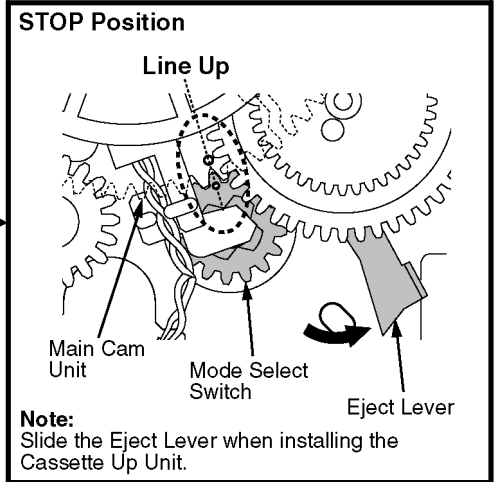
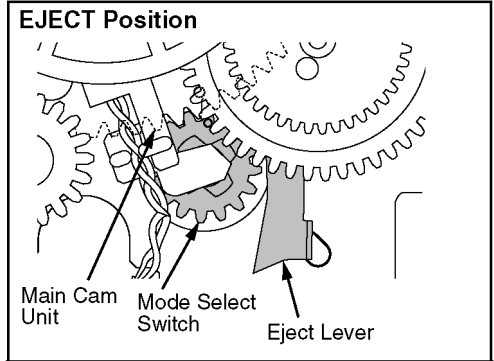
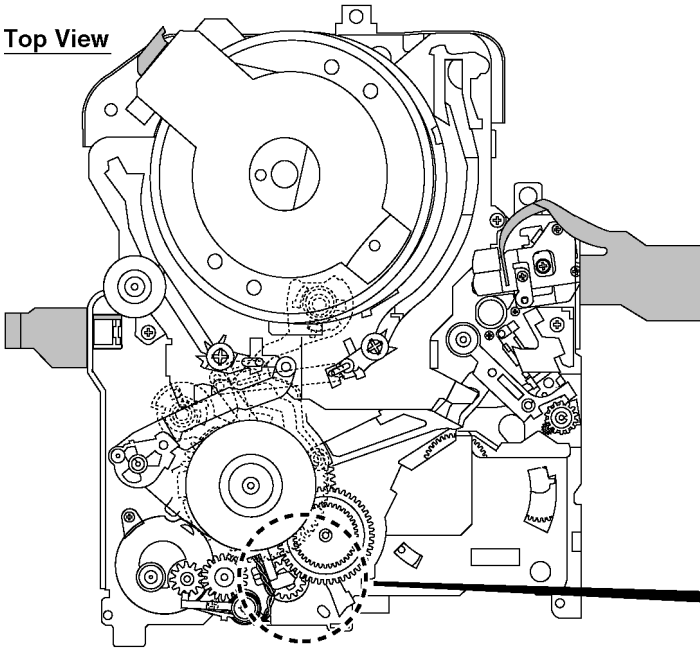

Fig. DM1-2

6.2.3. STOP Position Confirmation

Check the following alignment points to confirm that the Mechanism is in STOP Position from the Top and Bottom View.

Top View



Bottom View

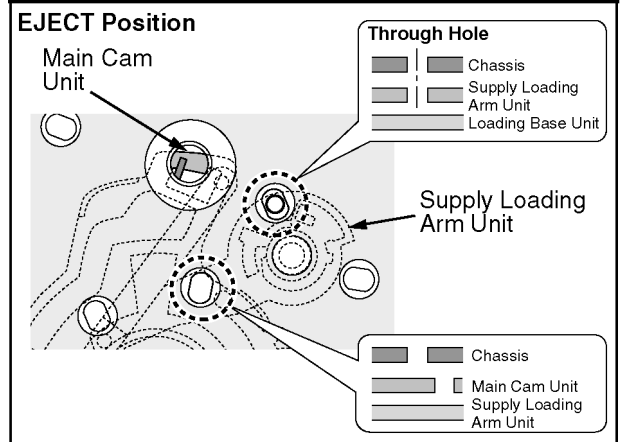
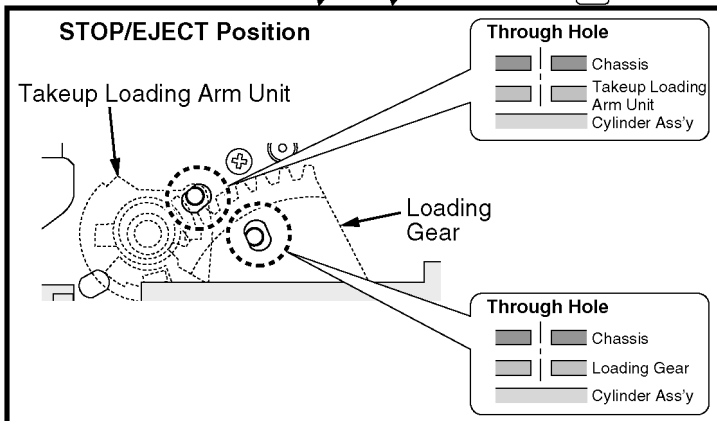
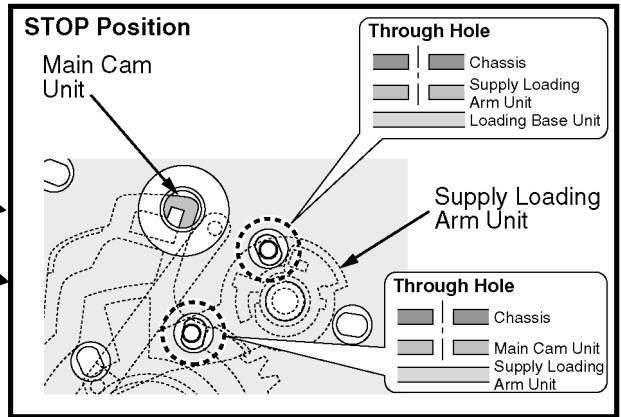
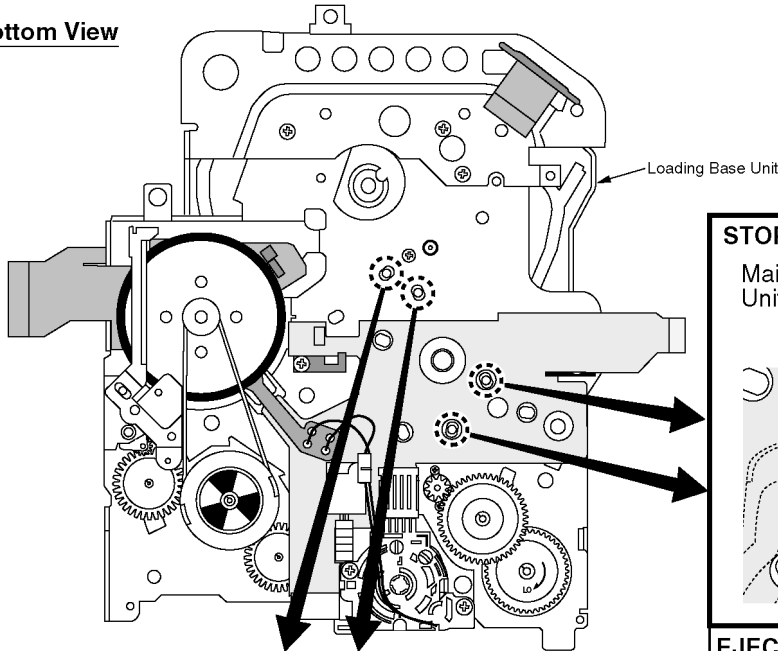

Fig. DM2

Perform all disassembly and alignments procedures in STOP Position except disassembly and alignment procedures which have the special Notes.

6.2.4. Cassette Up Unit

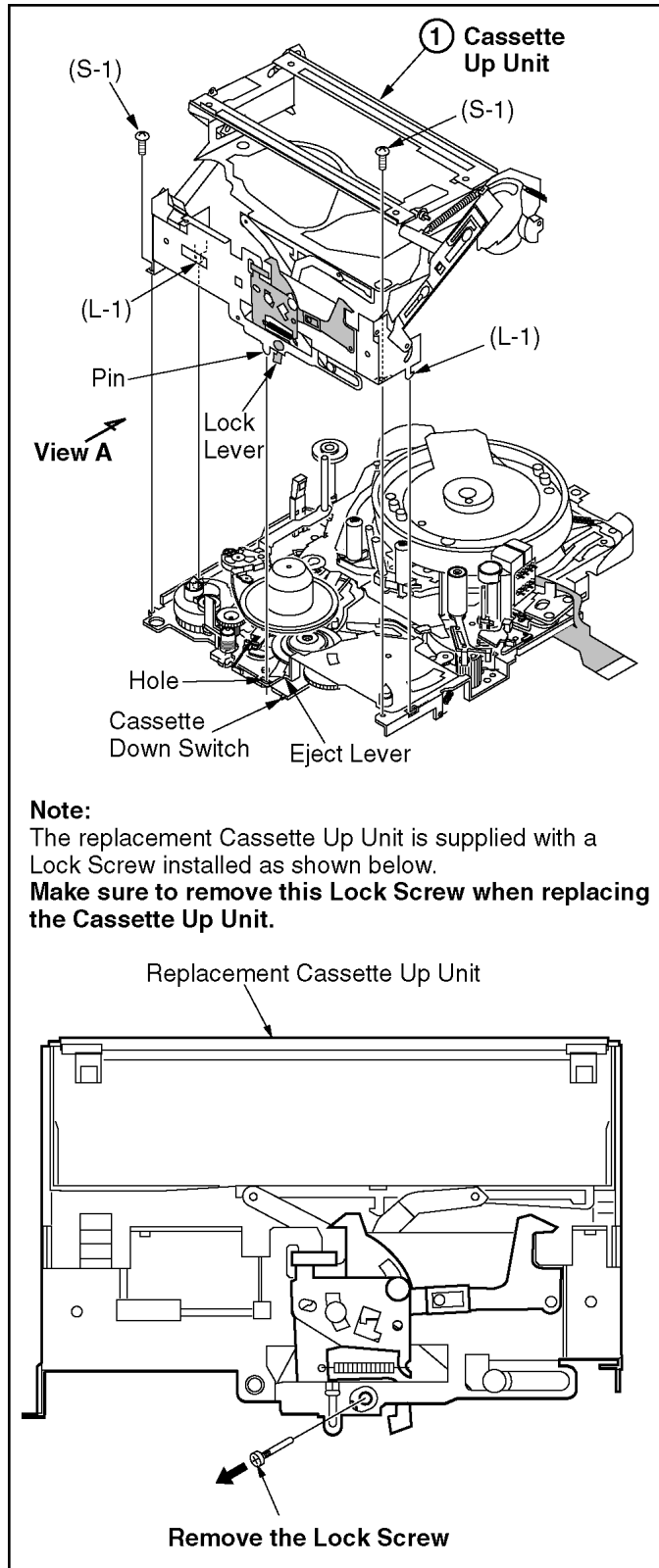

Fig. DM3-1

Reassembly Note:

1. Installation of the Cassette Up Unit

Installation is possible except when the Mechanism is in Eject Position.

- (1) Before installing the Cassette Up Unit, confirm that the Eject Lever is slid as shown.

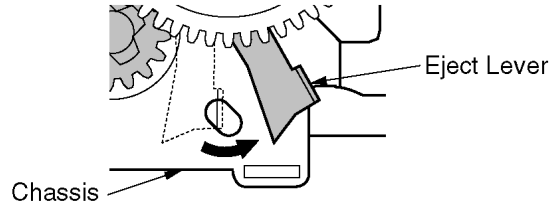

Top View

- (2) Slide the Lock Lever. (Otherwise, the Lock Lever may damage the Cassette Down Switch when installing the Cassette Up Unit.)

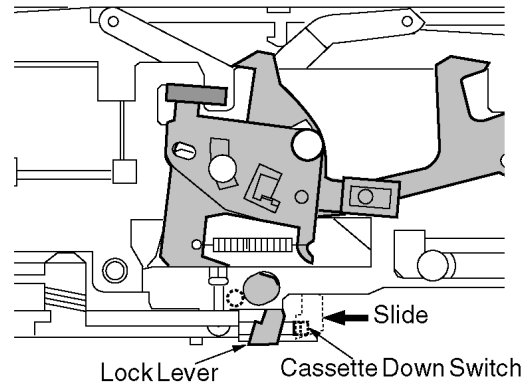

View A

- (3) Then, Install the Cassette Up Unit while setting 2 Locking Tabs (L-1). Next, insert Pin into Hole on the Chassis.
- (4) Slide the Cassette Up Unit as far as possible as indicated by the arrow. Then, tighten 2 Screws (S-1).

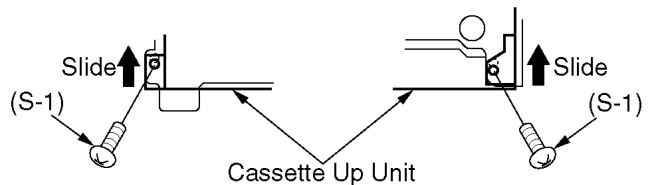

Top View

- (5) After installing the Cassette Up Unit, confirm that the Lock Lever is on the left of the Eject Lever as shown.

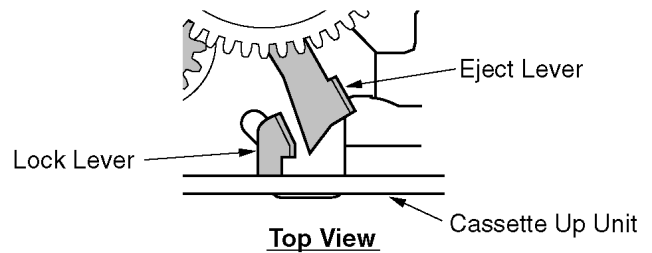

Top View

Fig. DM3-2

6.2.5. Cylinder Ass'y

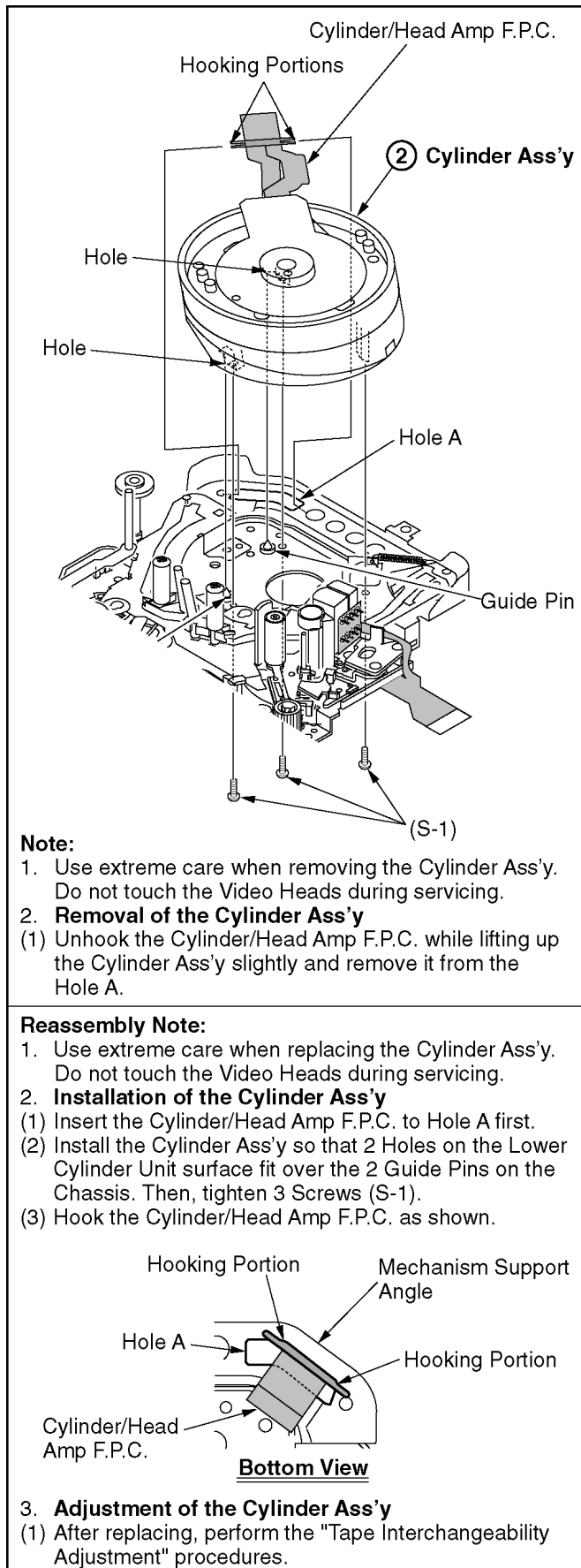

Fig. DM4-1-1

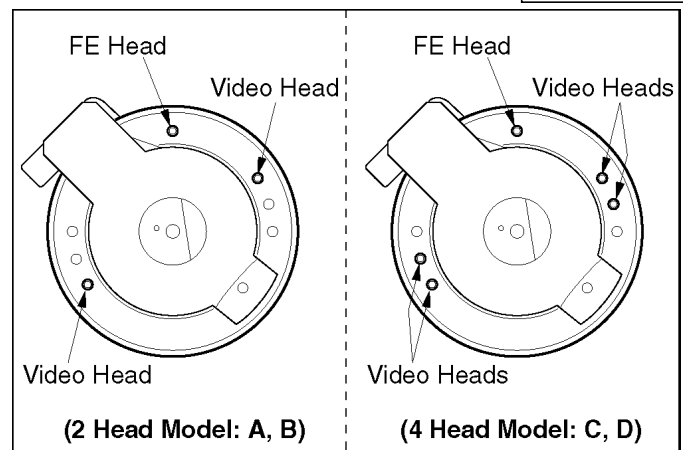

Fig. DM4-1-2